

Interior Design for Capital Foods

Nahuli, Vapi

Shortlisted Options- 15/06/2020

Reception Ground Floor

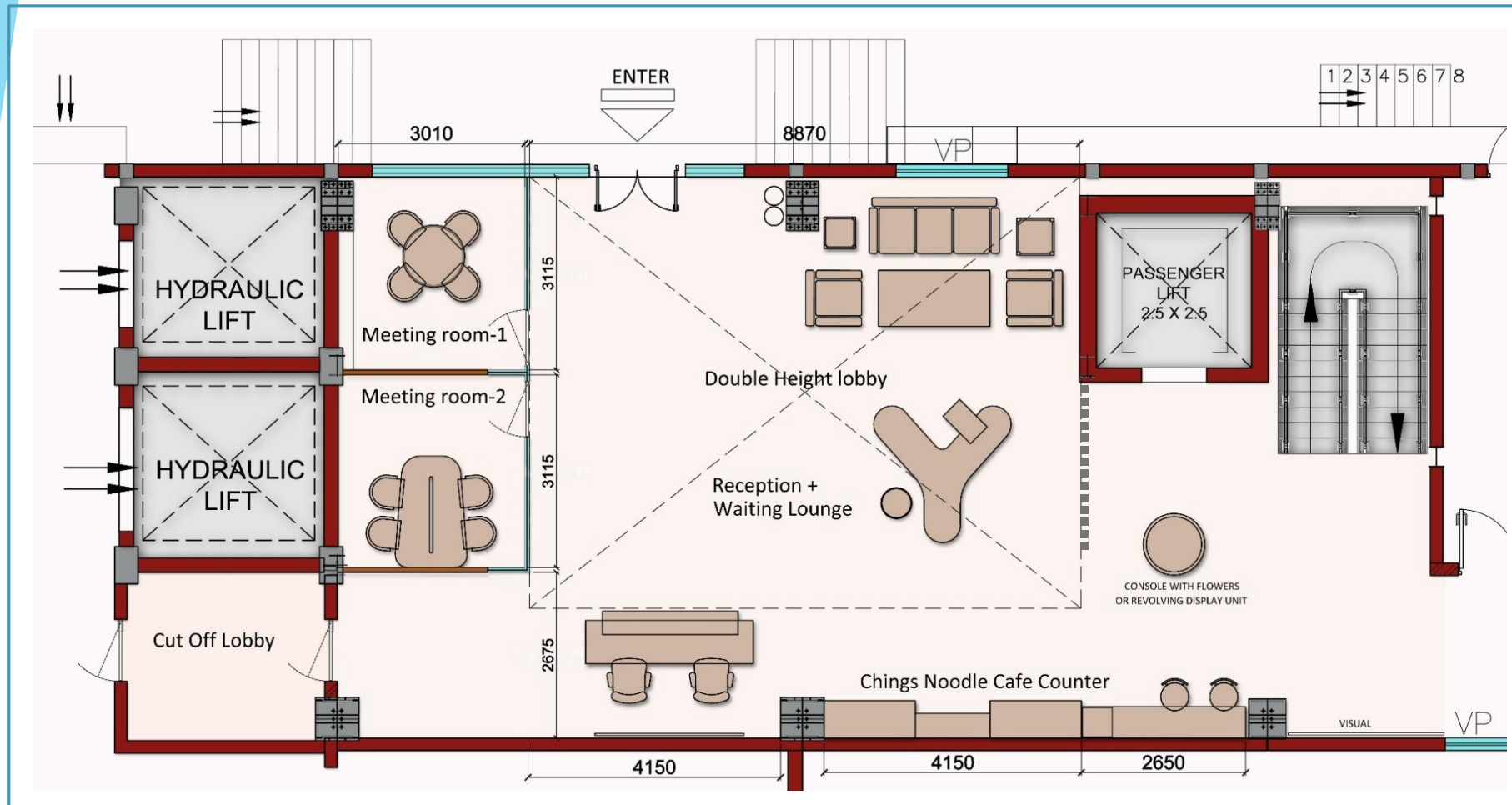

Total Area- 150 sq.m / 1617 sq.ft

- 2 x Meeting Rooms (20 sq.m / 215 sq.ft)
- Reception Area + Waiting Area (88 sq.m / 950 sq.ft)
- Lift Lobby (42 sq.m / 452 sq.ft)
- Café Counter
- Display Unit



Entrance

Waiting Area

Passenger Lift

Meeting Rooms

Hydraulic Lift

Ground Floor

Mezzanine Floor

Conceptual View

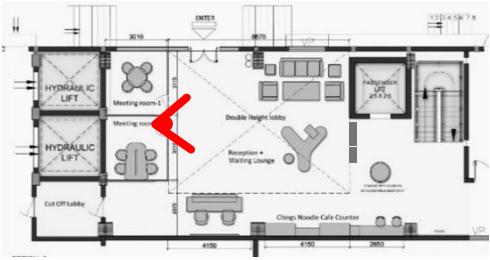

A formal setting will be adopted in terms of the color palate and finishes. With **complete false ceiling**, a **modern clean outlook** will be adopted for the reception area. Color will be added through a vertical **Green Wall** to add freshness to the ambience.



Reference Image

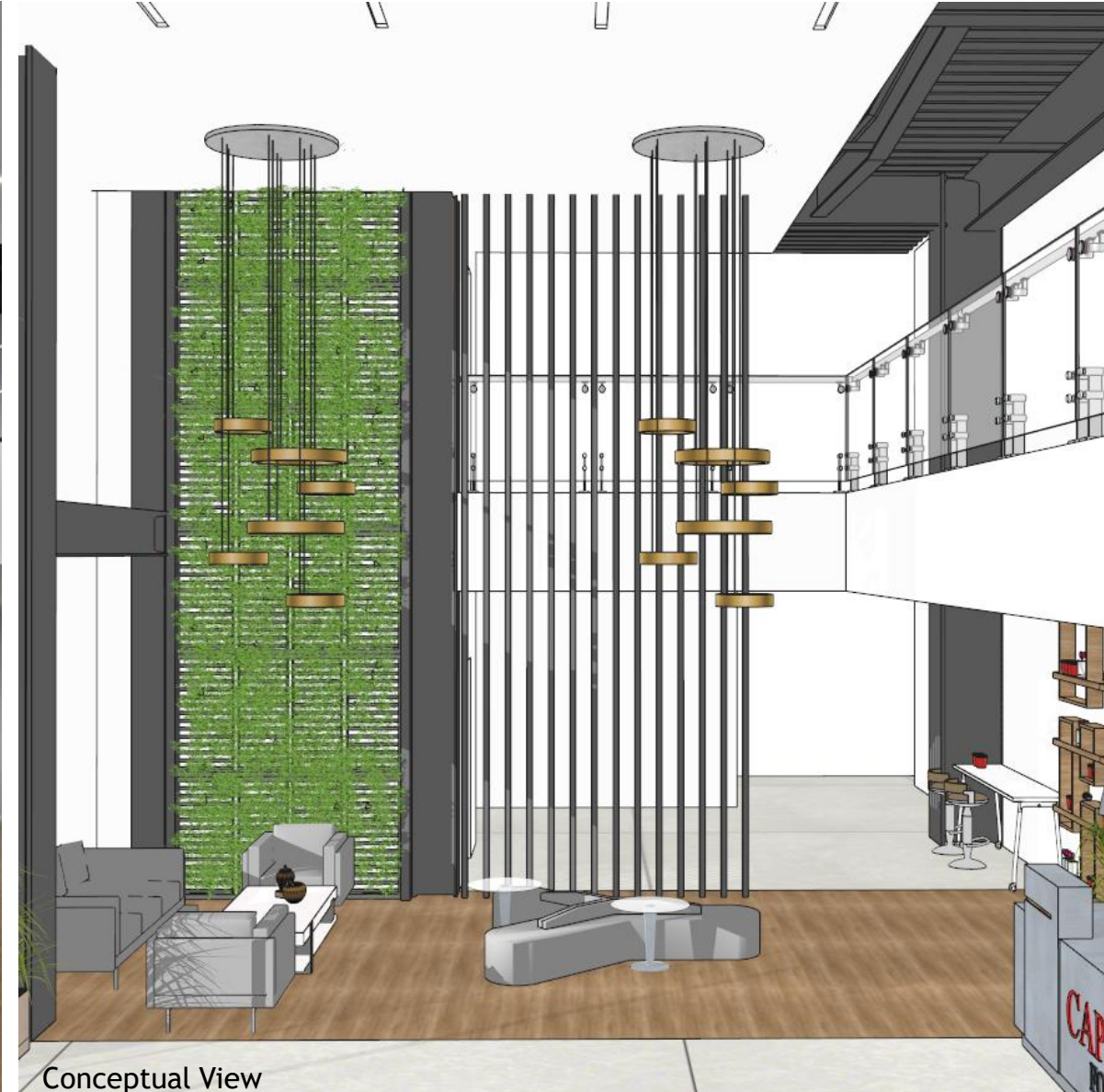

Conceptual View



Reference Image



Conceptual View

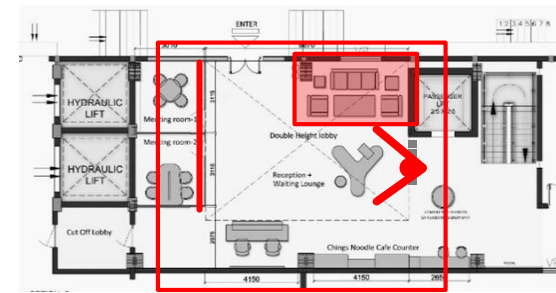

Bold **Double height frames** with clear glass will be used to create a **perfect balance** between a **modern** and an **industrial outlook**. To **break the monotony** of white and grey neutral **shades of tan** can be used in furniture to go with the formal setting. **Contemporary Hanging lights** can be used to enhance the **grandeur** of the space.



Reference Image



Conceptual View



The monotony of the formal setting will be broken by using a **pop color** making the interiors **formal** yet **lively**. The color can be introduced in the form of **metal/wooden louvers**. The furniture's color palette will be kept to neutrals to enhance the shades of the **bright colors** used.

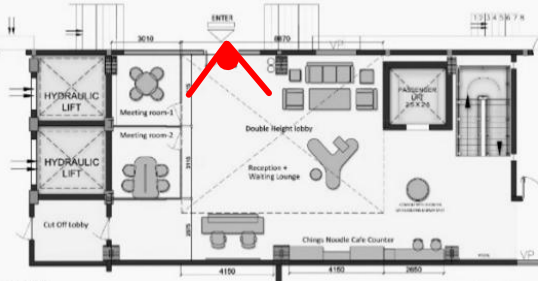

Key Plan

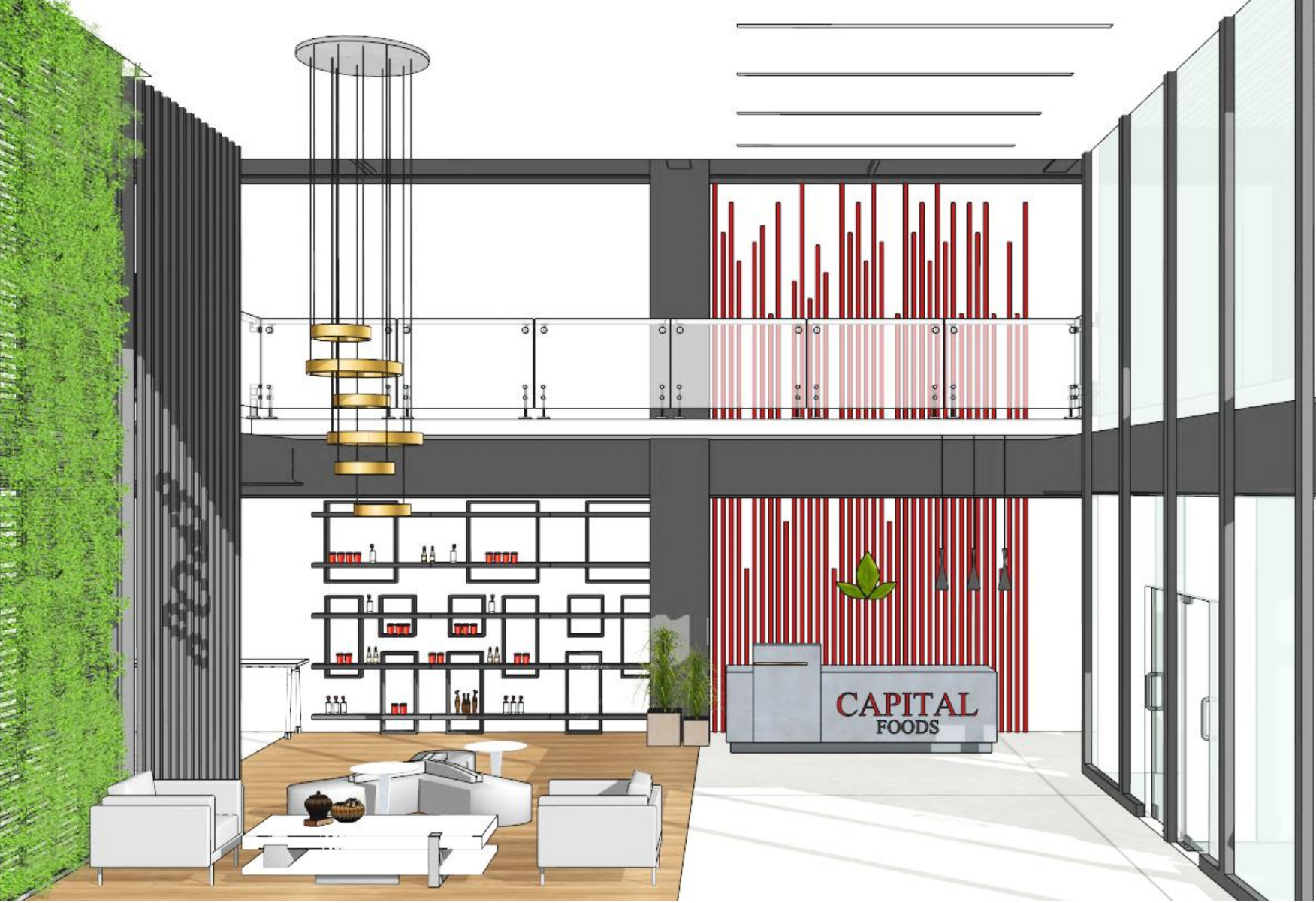

Conceptual View

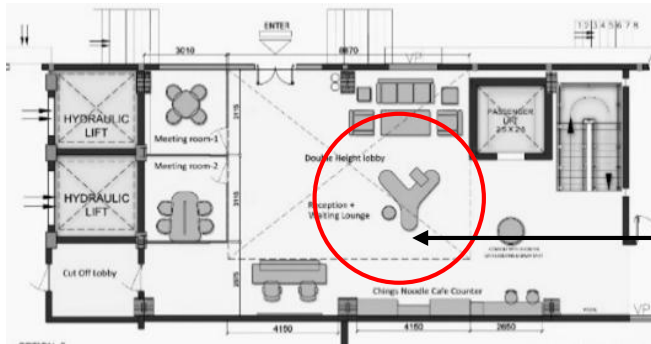

Statement Furniture

An **organic shaped informal seating** will be placed as a **statement piece** in the waiting area with a neutral palate depending upon the surroundings along with a formal set of seating.



OPTION 1



OPTION 2

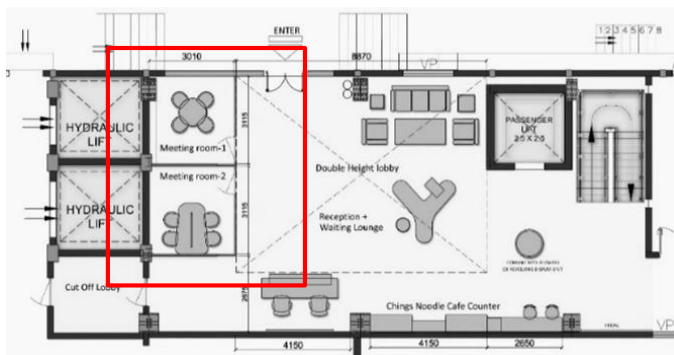

The meeting rooms will be kept **subtle** with **young and semi formal interiors**. The **industrial feel** of the space will be kept intact maintaining the **formal outlook** of the space.



Reference Image



Conceptual View

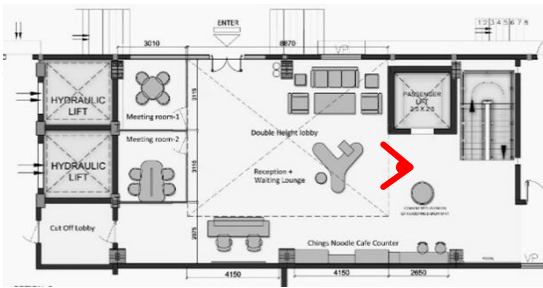

Key Plan



Conceptual View

Cafeteria

Ground Floor

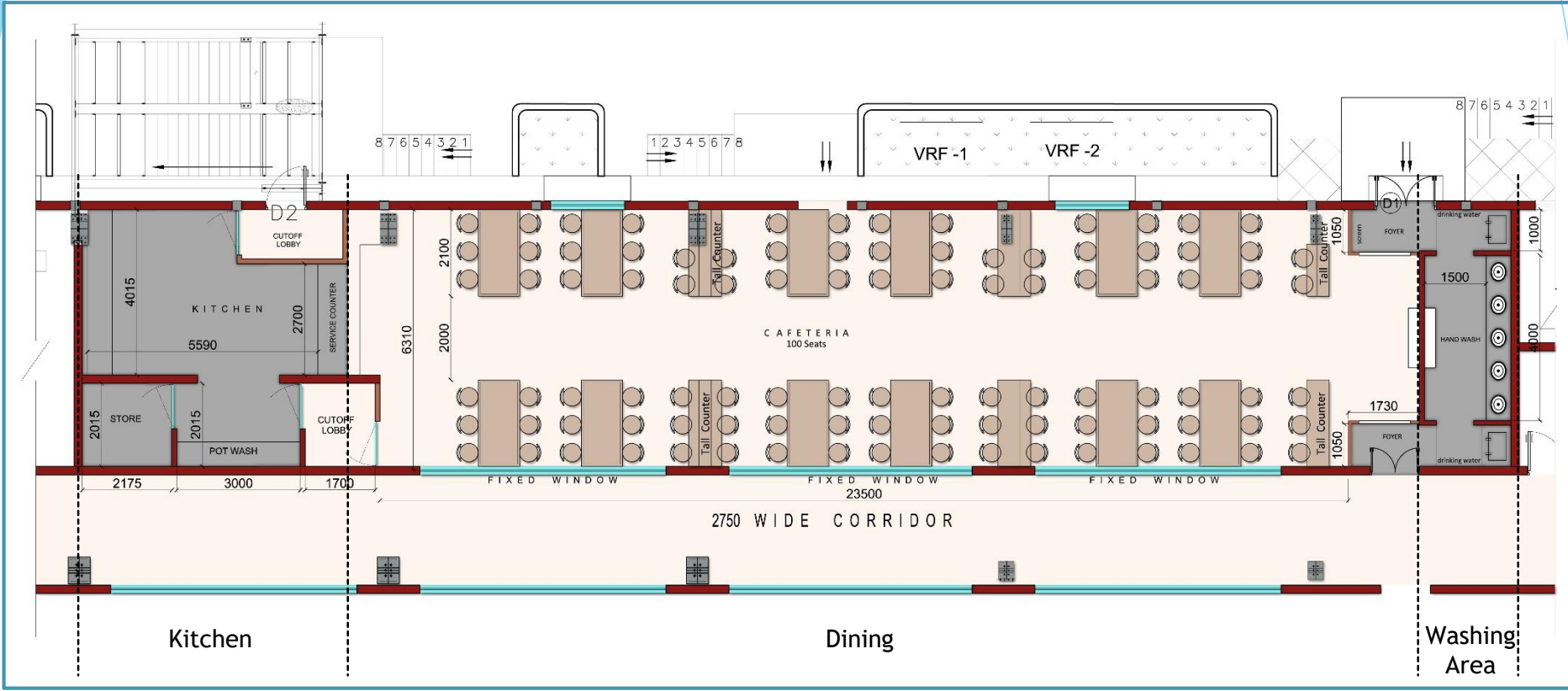

Total Area- 216 sq.m / 2325 sq.ft

- Kitchen (45 sq.m / 485 sq.ft)
- Dining (157 sq.m / 1690 sq.ft)
- Washing Area (14 sq.m / 150 sq.ft)

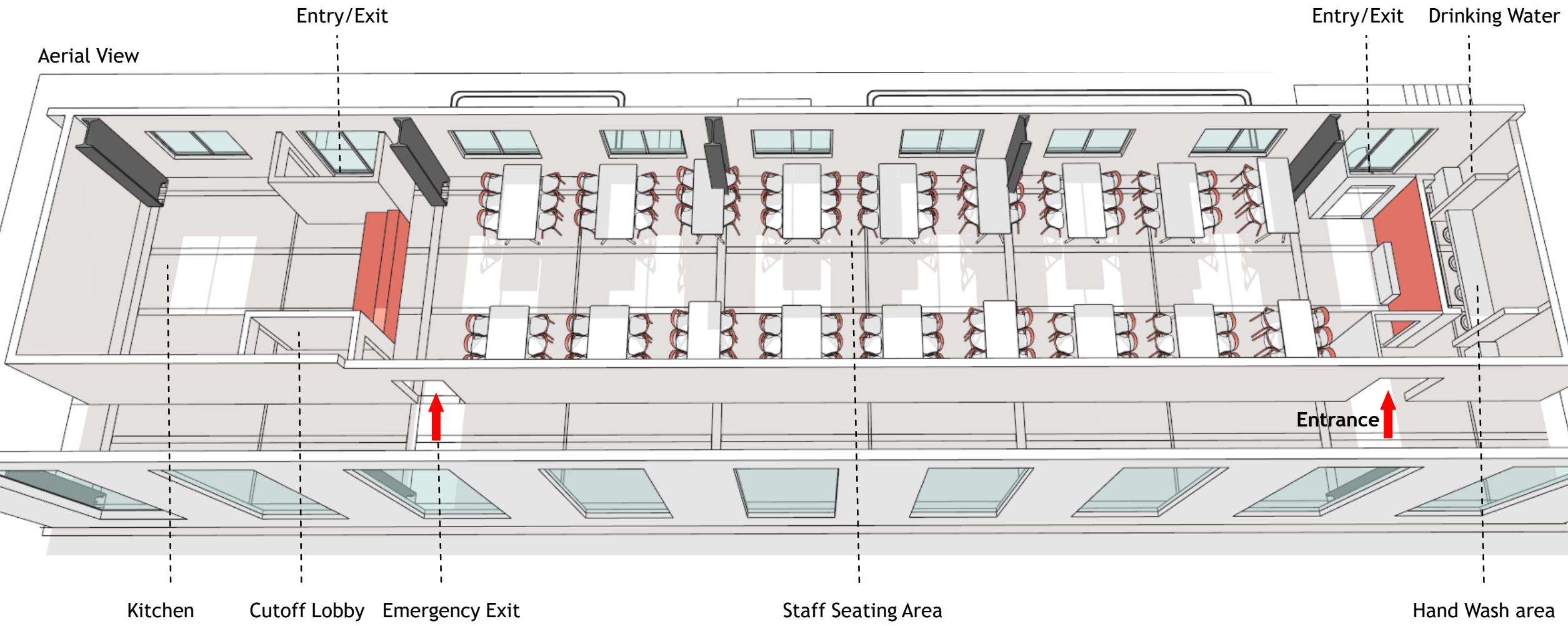

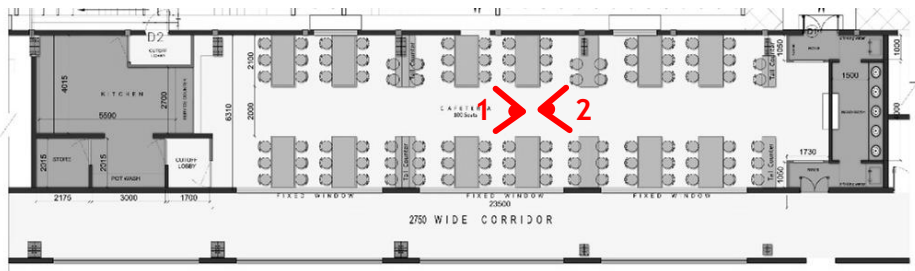

Key Plan

Cut off Lobby Serving Counter

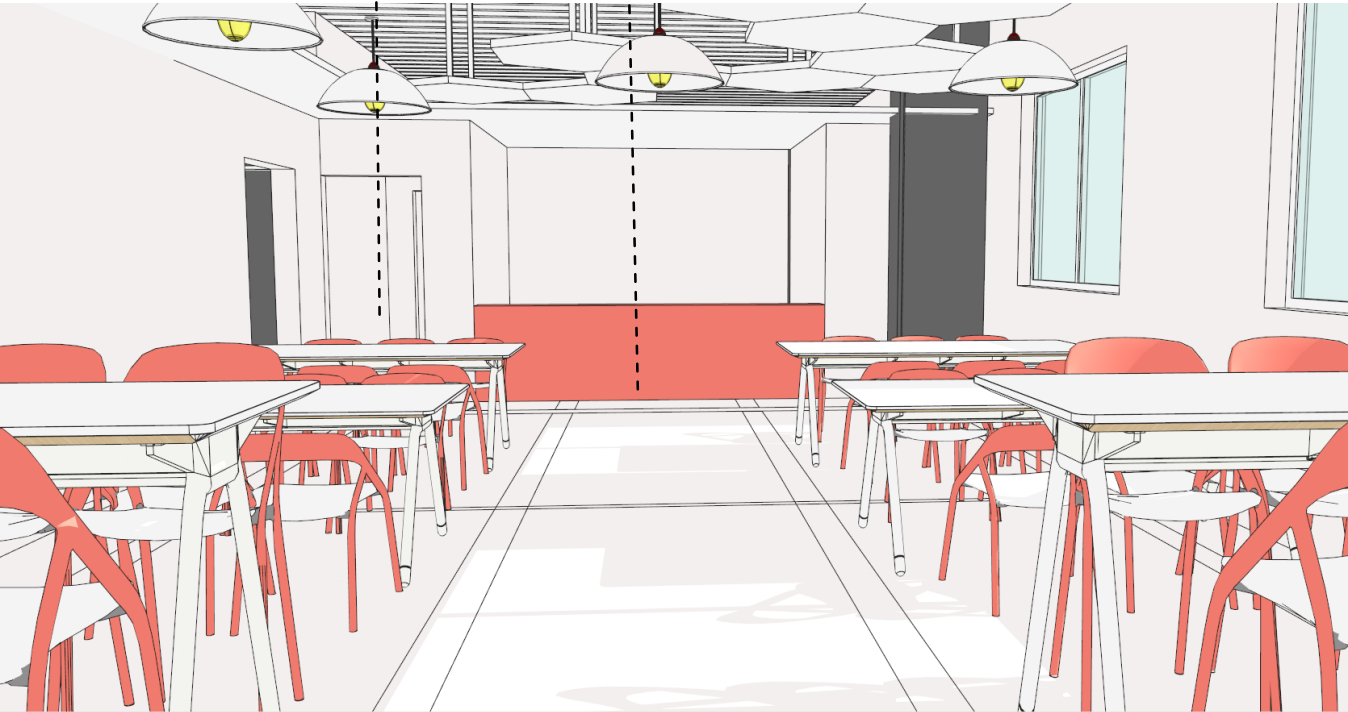

View 1

Hand wash area

Drinking water

Entrance Foyer

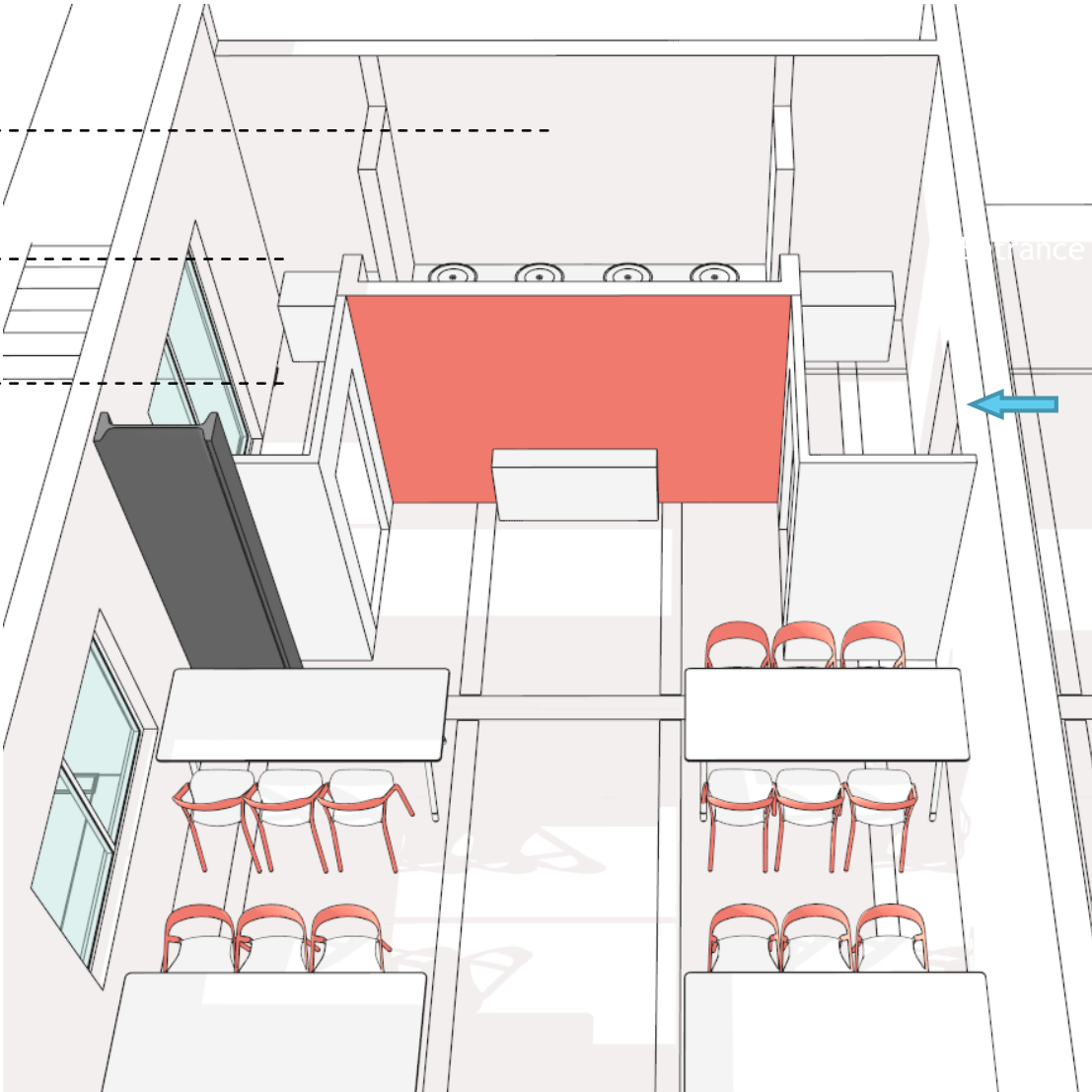

View 2



Reference Image



Conceptual View

A formal yet **playful cafeteria** design using **white** and a **vibrant color** like orange or green. The structural elements will be kept in **grey** to enhance the industrial ambience. Ceiling with **hanging lights** and **geometrical panels** designed in coherence to the **services** running through the ceiling.



Reference Image

Training Room

Ground Floor

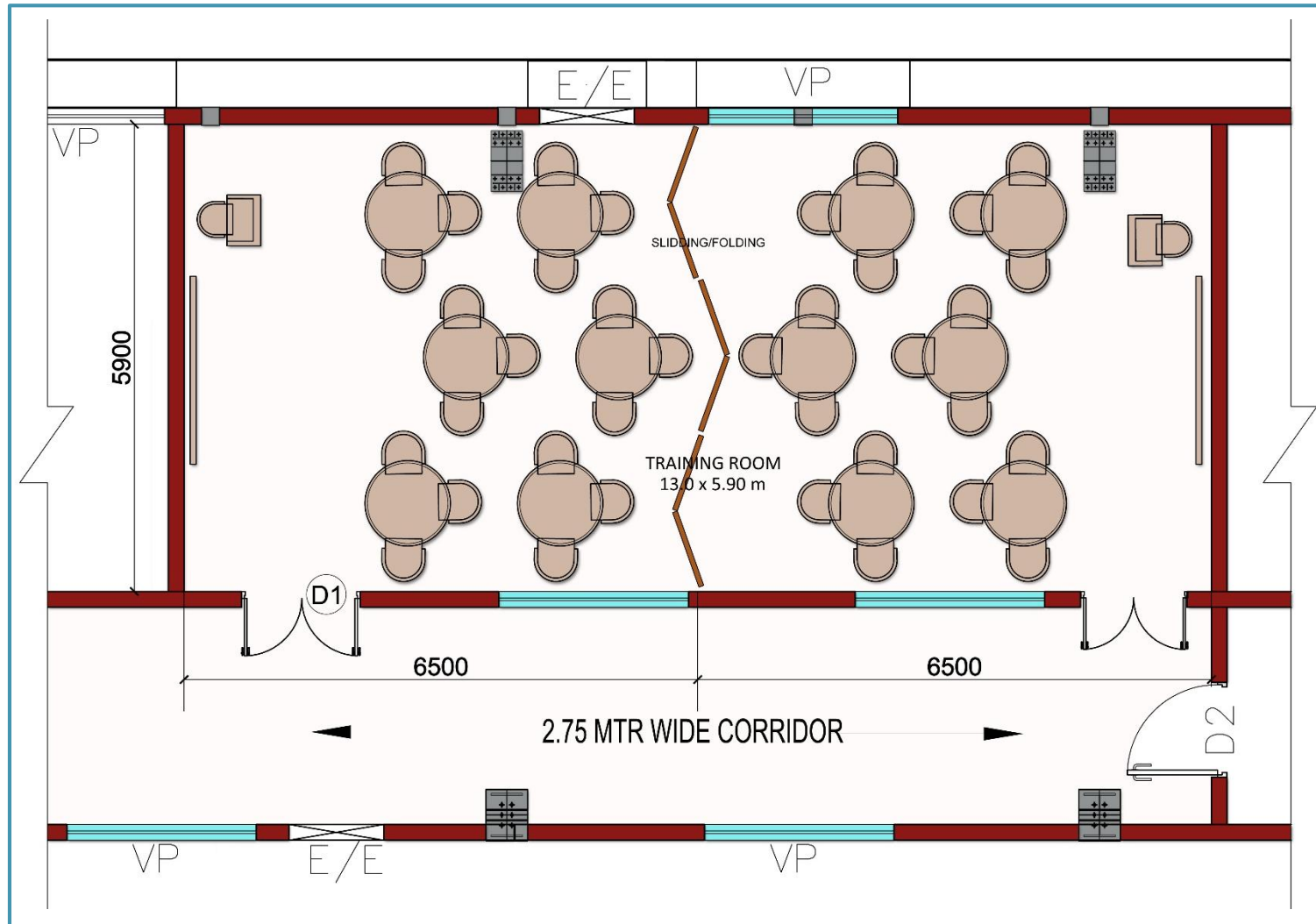

Total Area- 80 sq.m / 861 sq.ft

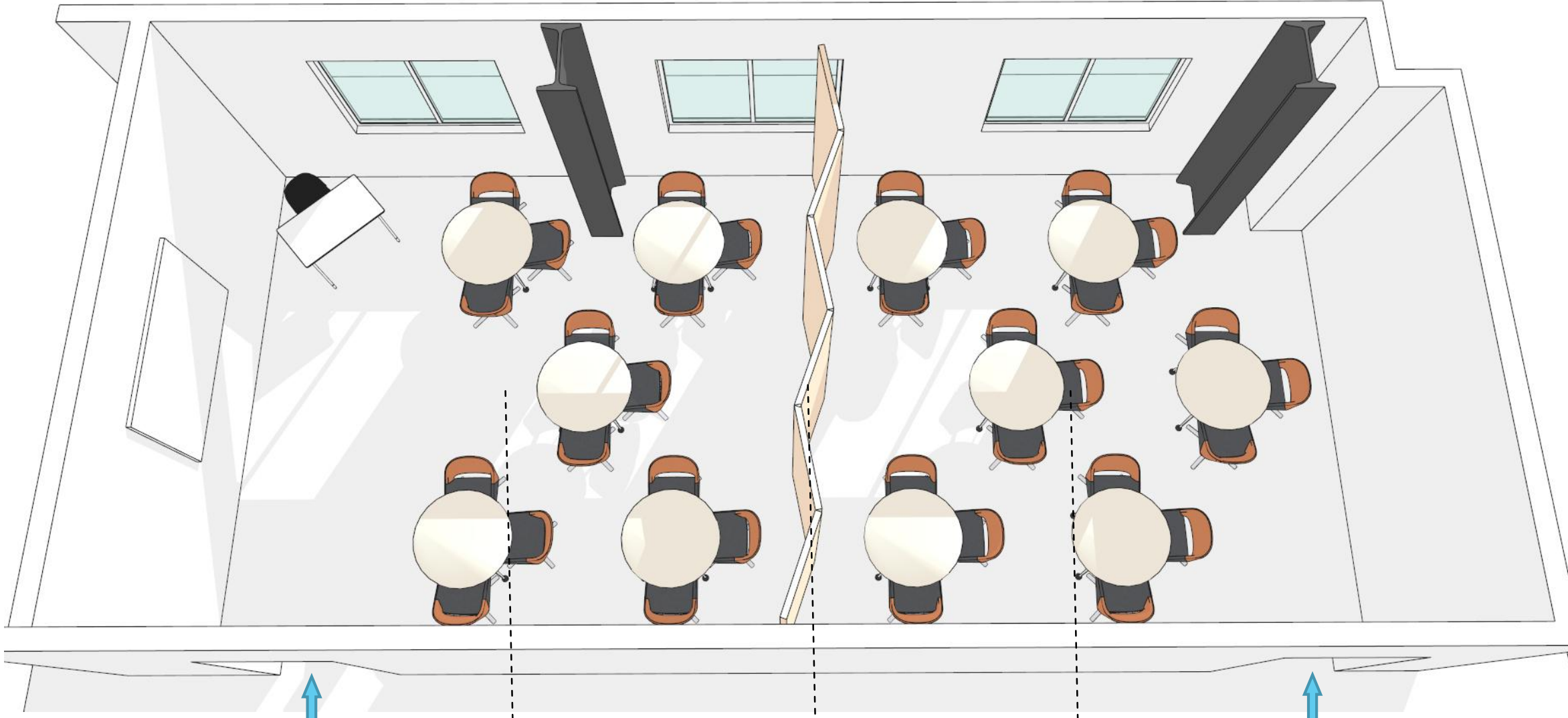

Entrance

Training Room 1

Folding Partition

Training Room 2

Entrance

Aerial View

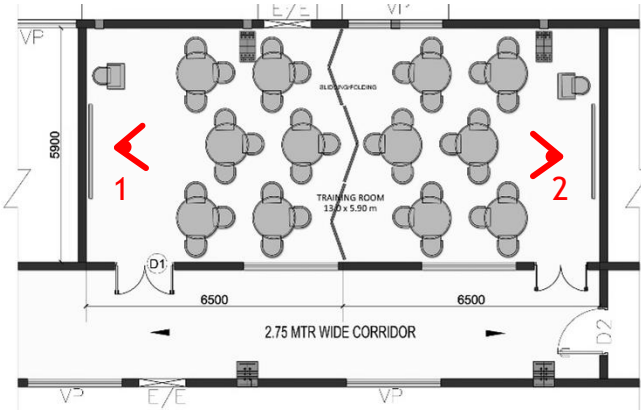

Key Plan

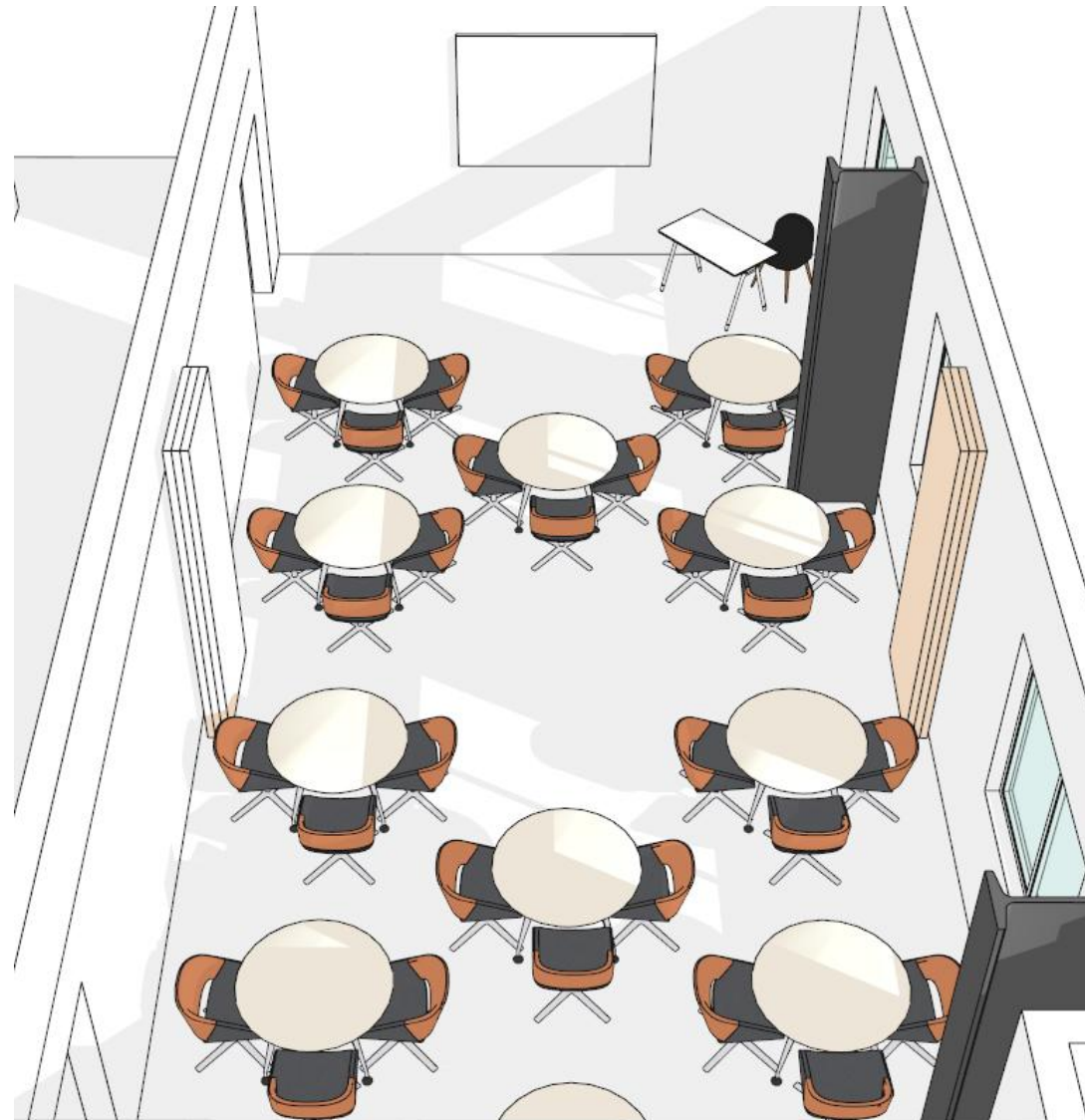

With partition open-2



With partition Closed-1

Conceptual View

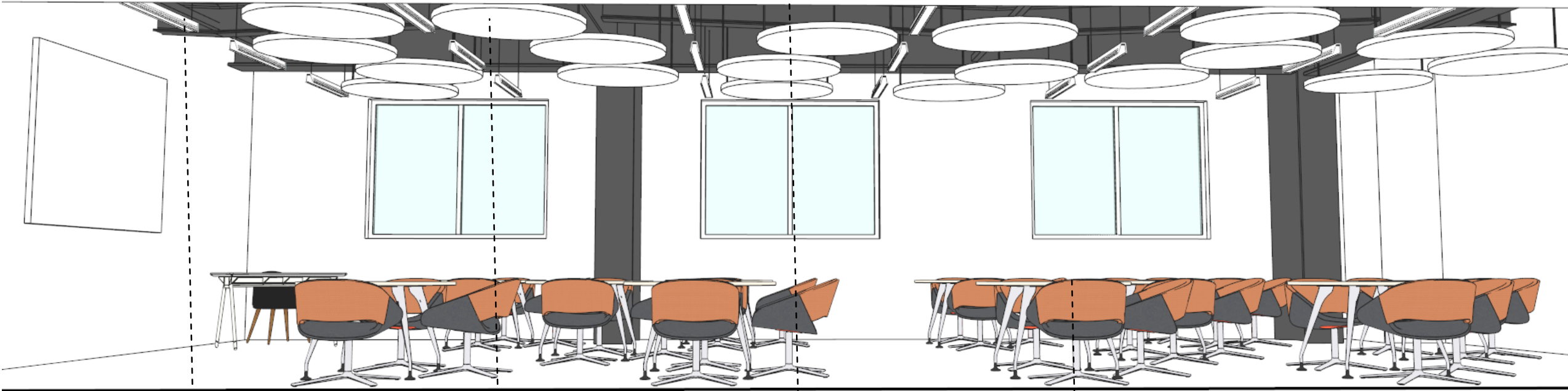
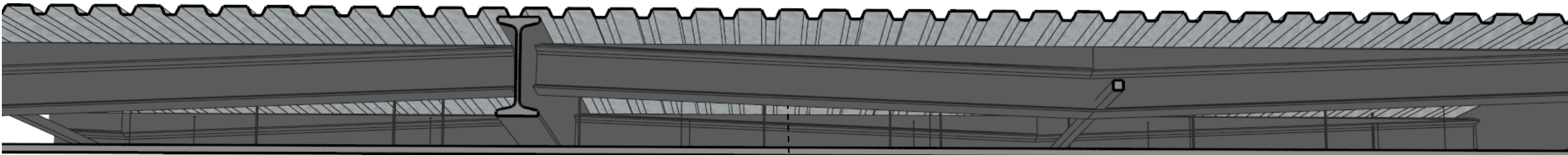

Linear Hanging Lights

Circular geometric panels

Exposed ceiling with structure and services in grey

Furniture in bright color



Approved Laminated Flooring

Admin Office

Mezzanine Floor

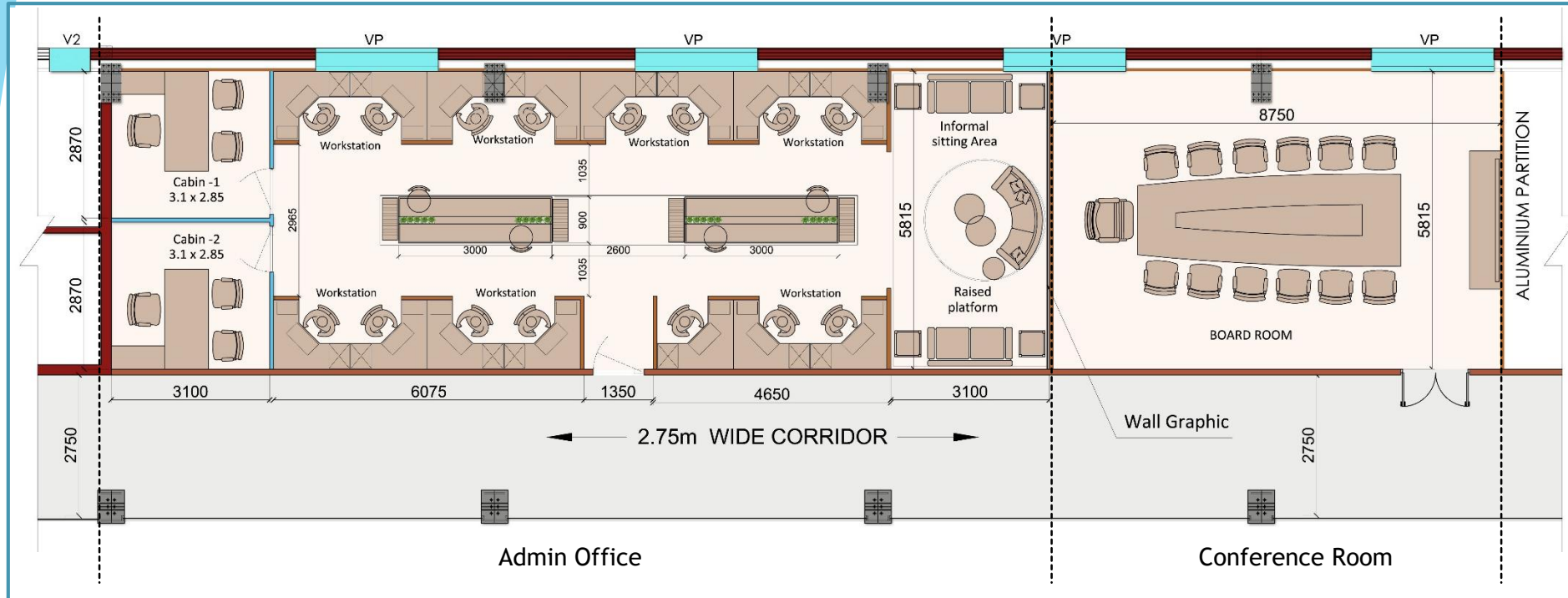

- Admin Office (115 sq.m / 1238 sq.ft)
- Conference Room (55 sq.m / 592 sq.ft)

Total Area- 170 sq.m / 1830 sq.ft

Admin office- Conceptual View

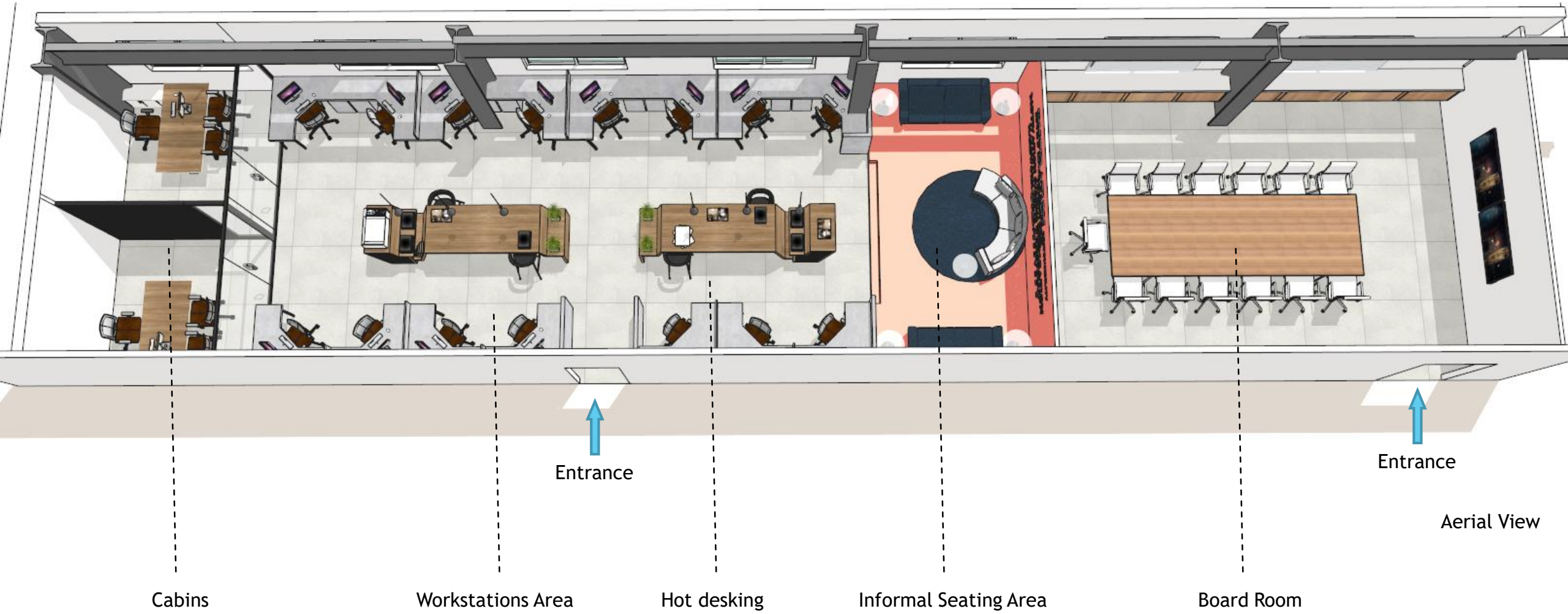

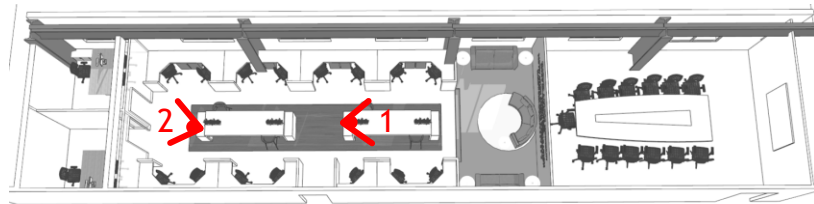

Cabins

Hot-Desking

Workstations Area



Informal Seating/ Lounge Area

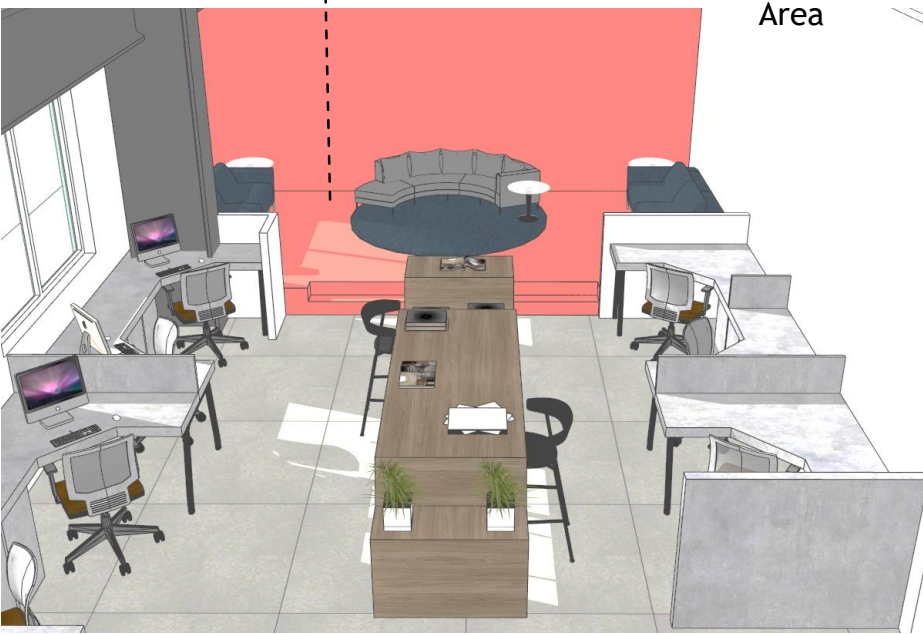

View 1

View 2

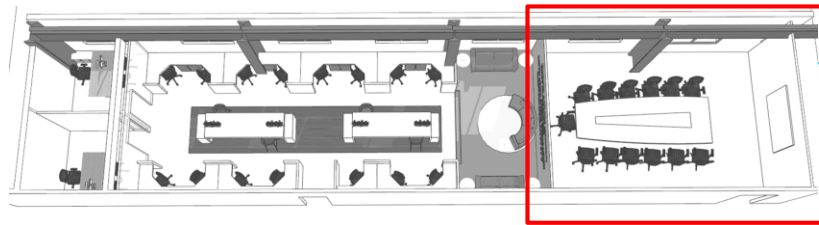

Key Plan

Board Room



Storage

2 set of screens on wall
with a rolled out
projector screen from
ceiling

Entrance

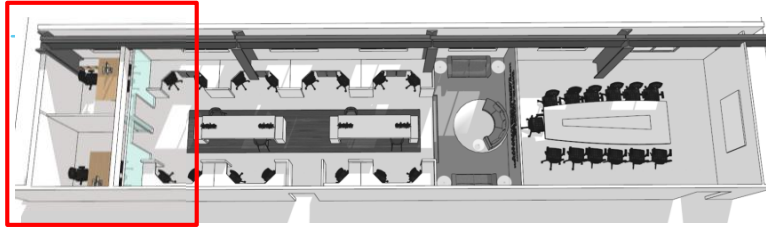

A completely **formal outlook** will be adopted for the administration area using a **formal color palate** as shown. Use of **clear glass** partition will reduce the heaviness of the color and provide transparency between the cabins and the workstation areas.



Reference Image



Conceptual View

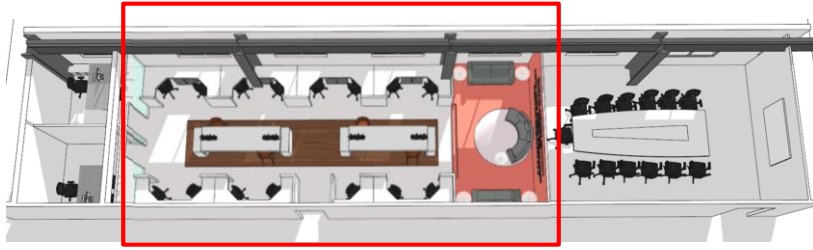

For the workstation area the color palate has been kept formal. **Wooden texture** has been used in combination to the **neutral grey hues**. **Linear lights** can be used forming a **pattern to add drama** to the space. The furniture will be kept in neutral tones of wood and grey. The ceiling will be kept **exposed with structure and services in grey** and **wooden textured ceiling** in cabins.



Reference Image



Conceptual View

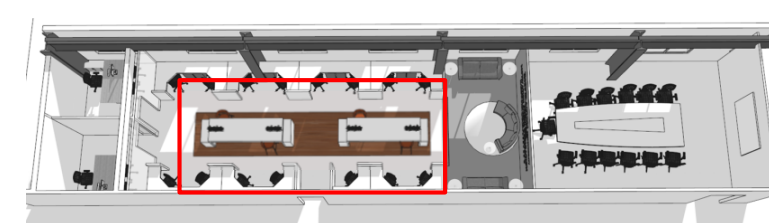

The **hot-desking furniture** will be designed in a manner to add some **drama** to the space as shown in the image. Simple **hanging lights** can be hung from the ceiling. This can provide a **casual space for working** as well as a small talk between the employees.



Reference Image

Conceptual View

Conceptual View



Conceptual View

In this option the lounge area will be given a **bright vibrant color scheme**. The wall will be **decorated with an artwork** created with **words essential in the efficient working** of an office.

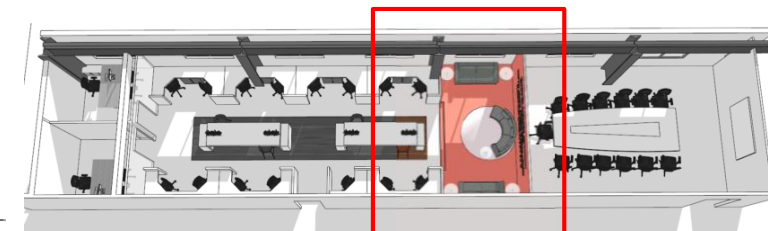



Conceptual View

Option 1- Rectangular Table

Admin office- Board Room

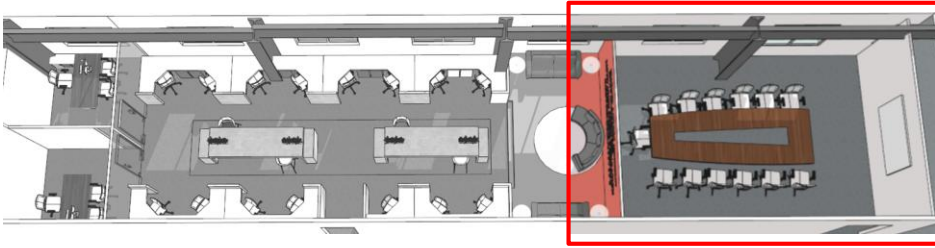

In this option the board room will have a **formal outlook**. Use of **wooden louvers** will be done in the ceiling to add warmth to the space.. The wooden texture will be balanced with the use of a **neutral color palate**. **Subtle, contemporary rectangular conference table** will add the required formal touch to the board room.



Reference Image



Conceptual View

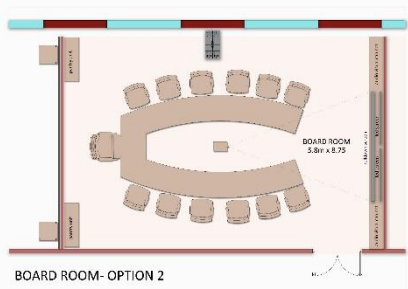

In this option the board room will have a **semi formal** ambience. Use of **wooden texture** would increase. A U-shape Conference Table would be added to with a wooden top with contemporary chairs.



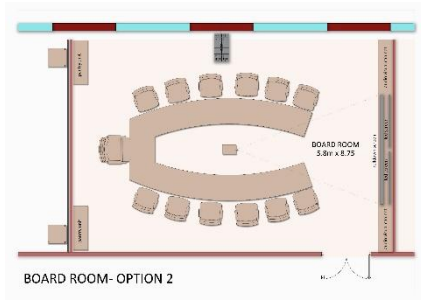

This Option is a **combination** of **Option 1 & 2**. We have used a **U shape Table** with **wooden top** as in option 2. The **ceiling** has been kept **formal** like option 1. The **color palate** has been kept Subtle with **shades of grey**. To add **warmth shades of browns** has been used.



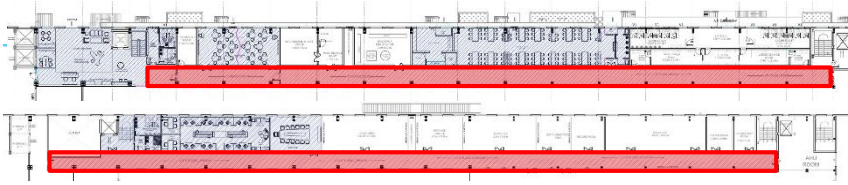

Conceptual View

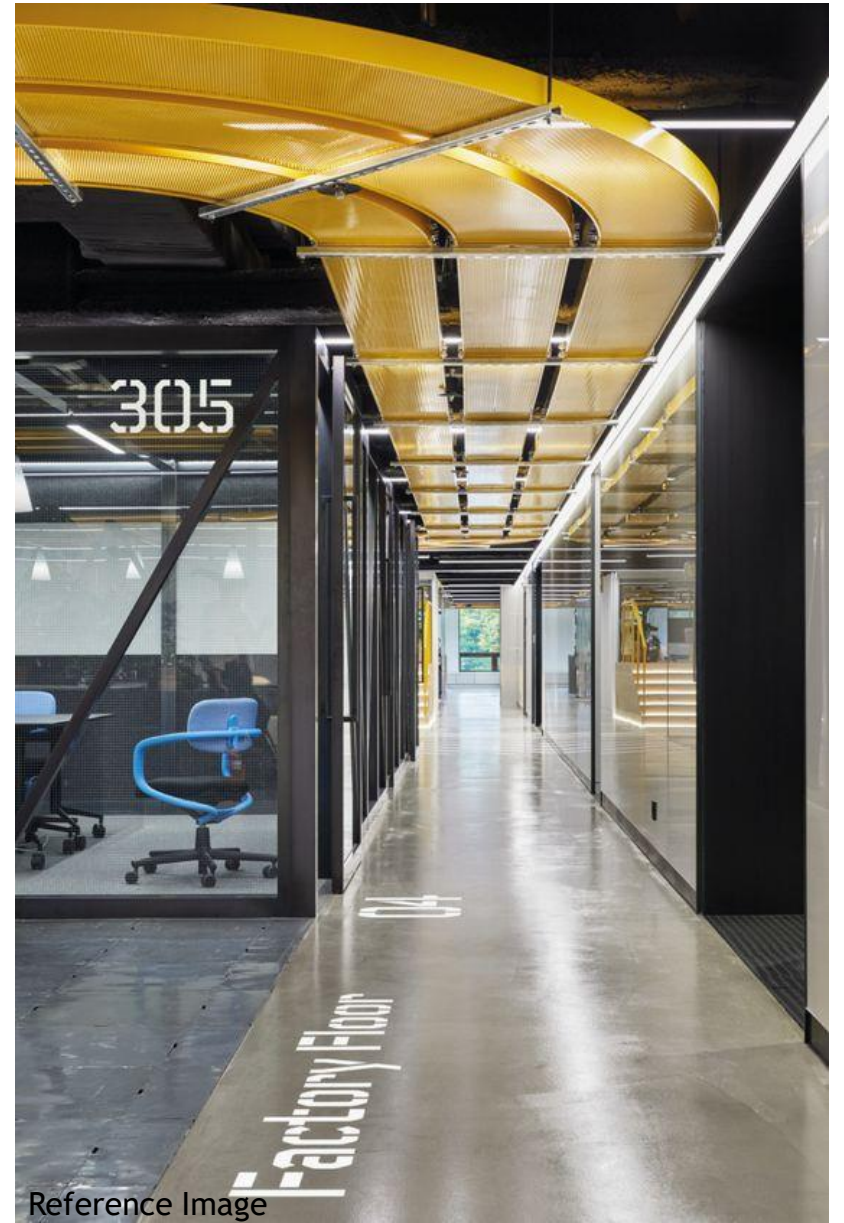

Reference Image

Thank You

